

CALCOLO SUPERFICIE LOTTO

Scala 1:500

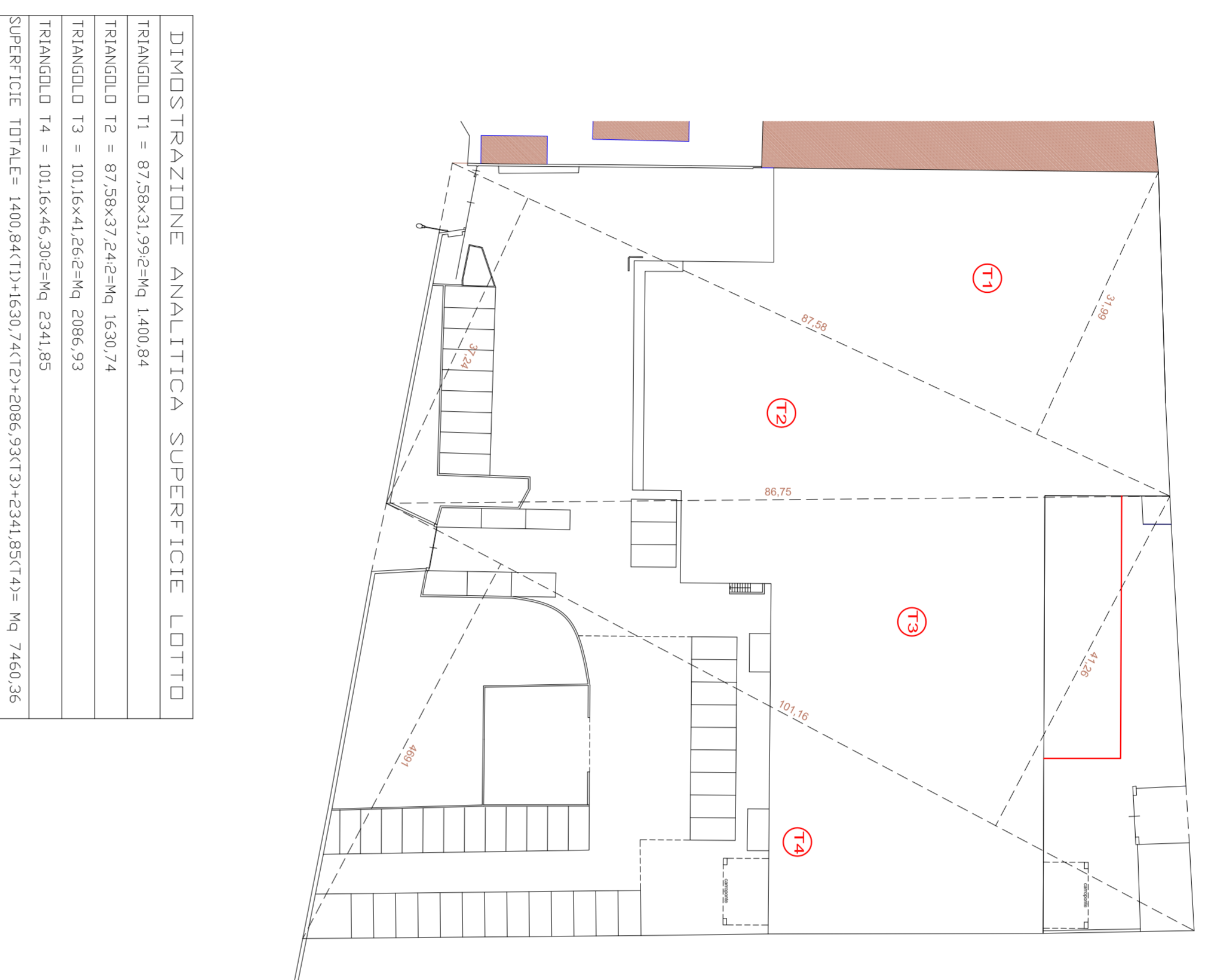

DIMOSTRAZIONE ANALITICA SUPERFICIE LOTTO

TRIANGOLO 11 =	87.586.013.994.94mq	1.400,84
TRIANGOLO 12 =	87.588.074.244.94mq	1.620,74
TRIANGOLO 13 =	101.164.414.686.94mq	8386,93
TRIANGOLO 14 =	101.163.443.107.94mq	23.141,95
SUPERFICIE TOTALE	190.040.171.143.94mq	32.952,47 mq

CALCOLO VERDE PROFONDO

Scala 1:500

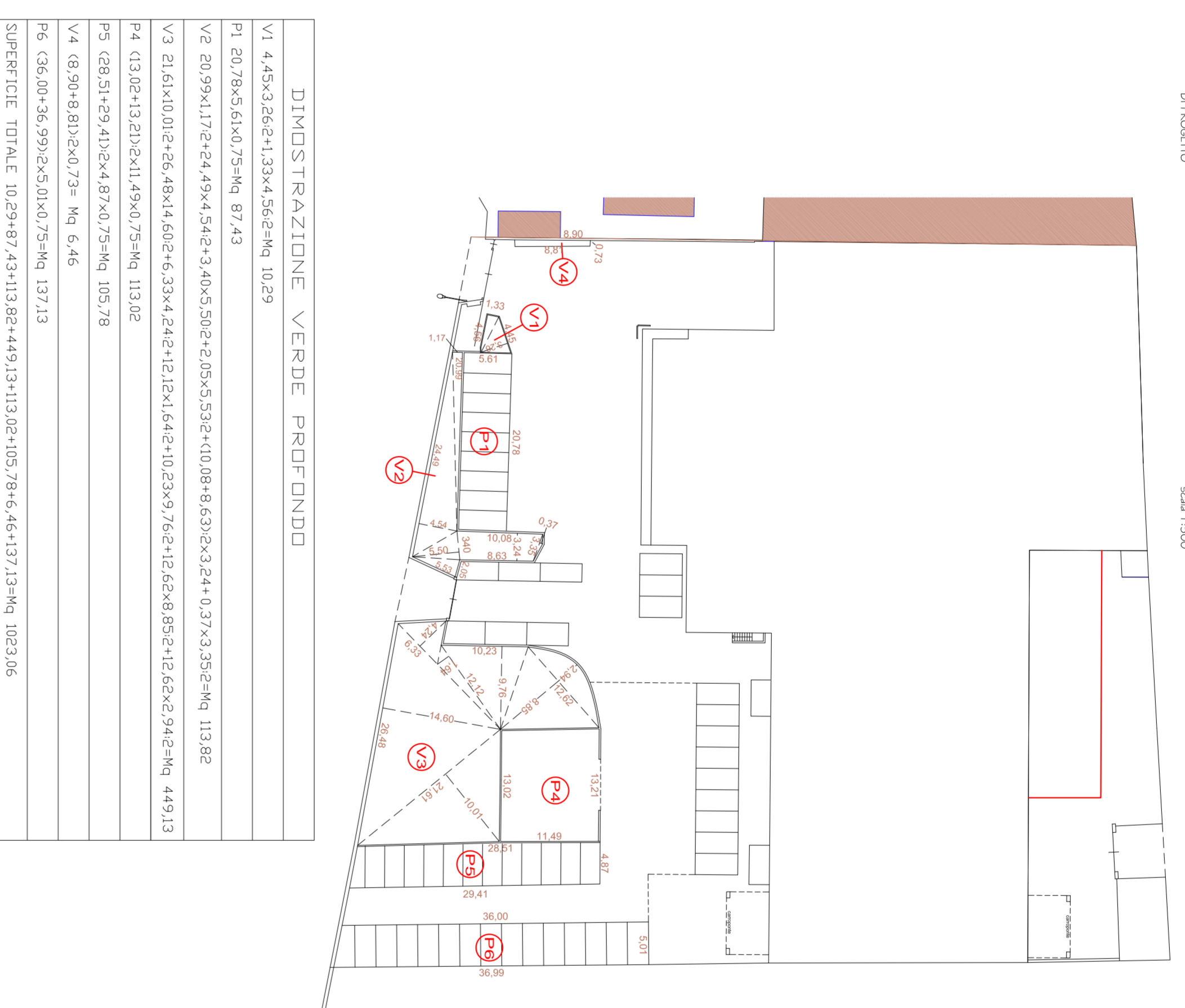

DIMOSTRAZIONE VERDE PROFONDO

V1	4.494.328.667.133.43mq	82,96
V2	80.780.564.072.94mq	87,243
V3	21.621.010.018.764.43mq	218,16
V4	48.936.48.038.032.94mq	80,646
V5	58.824.429.412.94mq	87,007
V6	63.242.412.94mq	87,007
V7	63.242.412.94mq	87,007
V8	63.242.412.94mq	87,007
V9	63.242.412.94mq	87,007
V10	63.242.412.94mq	87,007
V11	63.242.412.94mq	87,007
V12	63.242.412.94mq	87,007
V13	63.242.412.94mq	87,007
V14	63.242.412.94mq	87,007
V15	63.242.412.94mq	87,007
V16	63.242.412.94mq	87,007
V17	63.242.412.94mq	87,007
V18	63.242.412.94mq	87,007
V19	63.242.412.94mq	87,007
V20	63.242.412.94mq	87,007
V21	63.242.412.94mq	87,007
SUPERFICIE TOTALE	102.929,27 mq	102,92927 mq

CALCOLO SC ED SLP

Scala 1:500

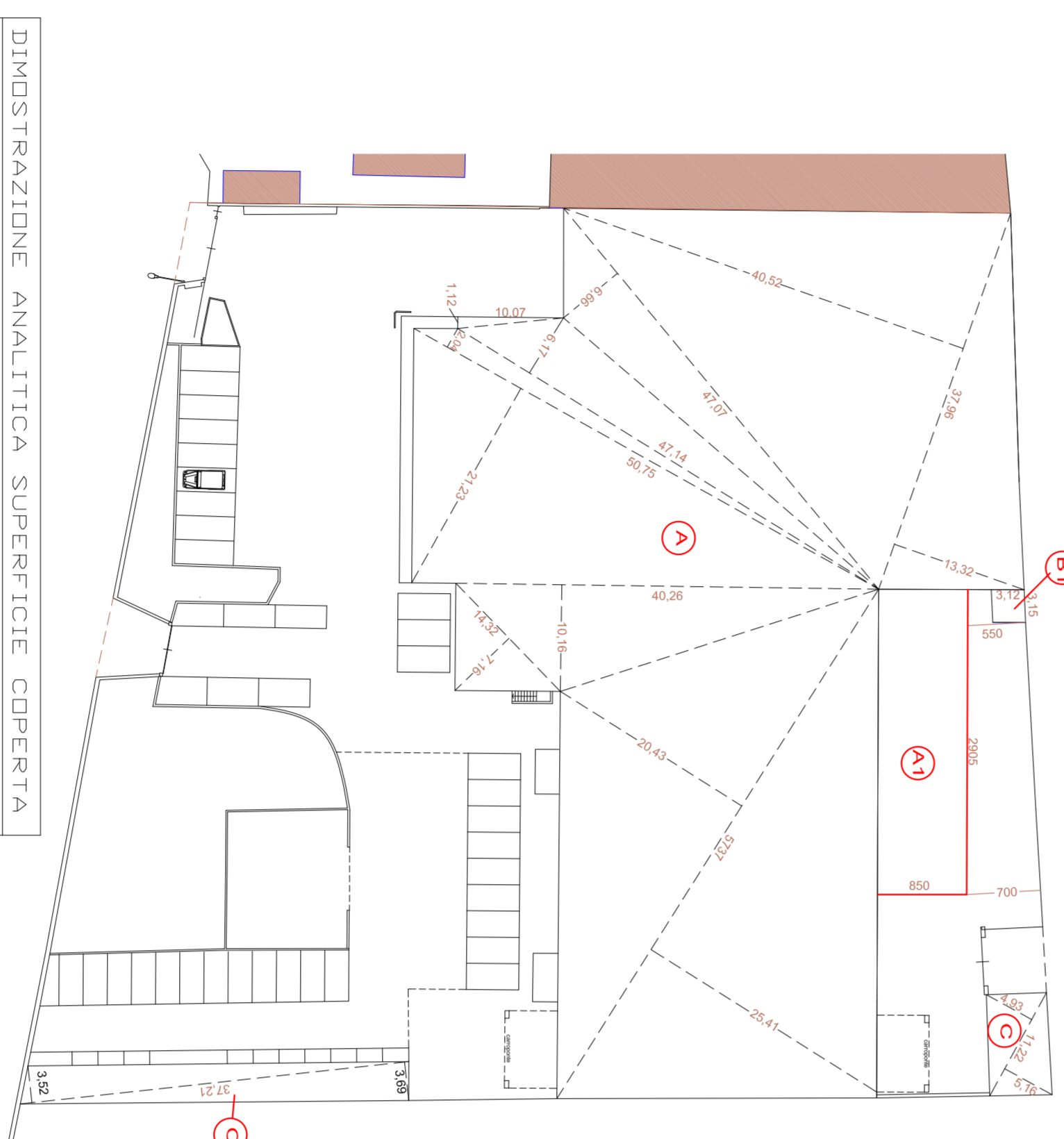

DIMOSTRAZIONE ANALITICA SUPERFICIE COPERTA

FABBRICATO A	57.272.824.418.572.94mq	113,28
FABBRICATO B	29.568.838	34,778
FABBRICATO C	11.255.366.11.255.366	52,58
FABBRICATO D	24.684.427.781.192.94mq	29,024
TOTALE	122.771.538.731.192.94mq	129,674

CALCOLO SUP. A PARCHEGGI

Scala 1:500

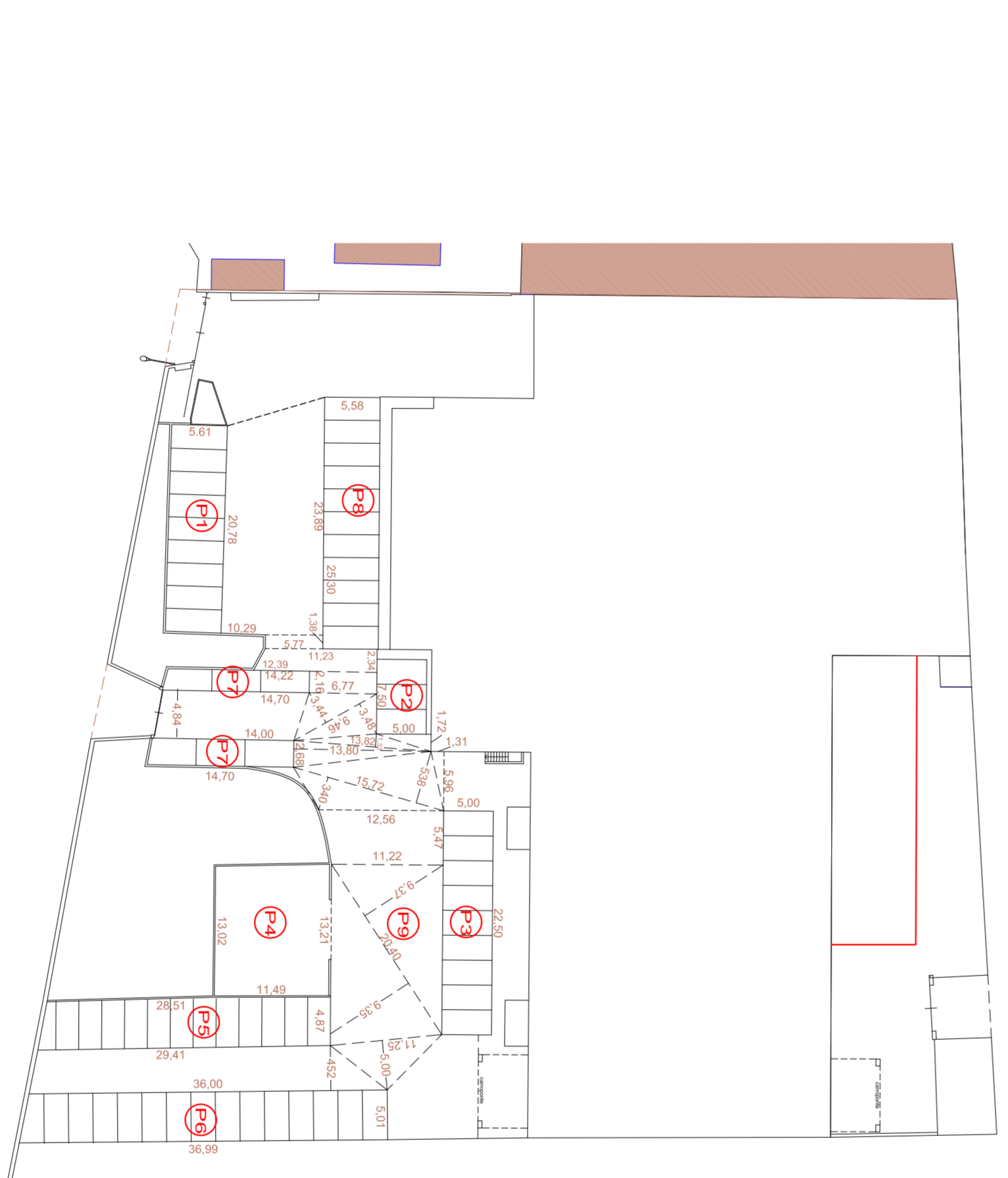

SUPERFICIE A PARCHEGGIO

P1	20.782.54.94mq	116,98
P2	24.007.25.94mq	37,50
P3	24.007.25.94mq	37,50
P4	11.255.366.11.255.366	52,58
P5	11.255.366.11.255.366	52,58
P6	11.255.366.11.255.366	52,58
P7	11.255.366.11.255.366	52,58
P8	11.255.366.11.255.366	52,58
P9	11.255.366.11.255.366	52,58
P10	11.255.366.11.255.366	52,58
P11	11.255.366.11.255.366	52,58
P12	11.255.366.11.255.366	52,58
P13	11.255.366.11.255.366	52,58
P14	11.255.366.11.255.366	52,58
P15	11.255.366.11.255.366	52,58
P16	11.255.366.11.255.366	52,58
P17	11.255.366.11.255.366	52,58
P18	11.255.366.11.255.366	52,58
P19	11.255.366.11.255.366	52,58
P20	11.255.366.11.255.366	52,58
P21	11.255.366.11.255.366	52,58
SUPERFICIE TOTALE	316.589,37 mq	316,58937 mq

COMUNE DI ROVATO PROVINCIA DI BRESCIA

VARIANTE AL PIANO DI RECUPERO
 APPROVATO CON DELIBERA DI GIUNTA N.42 DEL 19.02.2018

PROGETTISTA: Geom. Moreno Lorenzi
 PROGETTISTA: Inq. Luca Dotti
 COMMITTENTE: Sapp Immobiliare s.r.l.

**Studio di Progettazione
 Lorenzi Gaoni, Moreno**
 Cocaglio (BS) - Viale G. Matteotti 5 - Tel. 030.770557 - email: lorenzimoreno@gmail.com
 Casa Via Lilla 1941 - 25015 - P.le. Italia 5107529998

Ing. DOTTI LUCA
 Studio Tecnico
 Ing. Luca Dotti
 Via San Pietro 19 - 25015 - P.le. Italia 5107529998

04

PROGETTO: ...
 DATA: ...
 SCALE: ...
 DATA: ...